

KEYED NOTES NOTE: NOT ALL KEYED NOTES WILL BE USED ON THIS SHEET.

- ① EXISTING DUKE ENERGY STREET LIGHTING POLE. NO ACTION IS REQUIRED BY THIS CONTRACT. ALL WORK ASSOCIATED WITH THESE POLES ARE IN ANOTHER CONTRACT BY HINDE AND DUKE ENERGY.
- ② EXISTING DUKE ENERGY PEDESTRIAN LIGHTING POLE. NO ACTION IS REQUIRED BY THIS CONTRACT. ALL WORK ASSOCIATED WITH THESE POLES ARE IN ANOTHER CONTRACT BY HINDE AND DUKE ENERGY.
- ③ EXISTING UNCC PEDESTRIAN LIGHT POLE TO BE REMOVED.
- ④ EXISTING UNCC PEDESTRIAN LIGHT POLE TO REMAIN.
- ⑤ EXISTING UNCC PARKING LOT LIGHT POLE TO REMAIN.
- ⑥ EXISTING UNCC PARKING LOT LIGHT POLE TO BE REMOVED. REMOVE ASSOCIATED UNDER GROUND WIRING.
- ⑦ EXISTING EMERGENCY BLUE LIGHT PHONE TO BE REMOVED.
- ⑧ EXISTING UNCC LED STREET LIGHT POLE TO BE RELOCATED. REMOVE FROM CONCRETE BASE AND STORE (PROTECTED) UNTIL READY FOR INSTALLATION AT NEW LOCATION.
- ⑨ EXISTING CONCRETE BASE FOR LIGHT POLE TO BE REMOVED ALONG WITH ASSOCIATED UNDERGROUND WIRING.
- ⑩ TIE TO EXISTING CIRCUIT #13 PANEL (L1), 277V, 1 PHASE
- ⑪ TIE TO EXISTING CIRCUIT #15 PANEL (L1), 277V, 1 PHASE
- ⑫ TIE TO EXISTING CIRCUIT #5 PANEL (L1), 277V, 1 PHASE
- ⑬ TIE TO EXISTING CIRCUIT #7 PANEL (L1), 277V, 1 PHASE
- ⑭ NEW POSITION OF RELOCATED LIGHT POLE 'SCR'. PROVIDE NEW CONCRETE BASE PER DETAILS.
- ⑮ TIE TO EXISTING CIRCUIT #1 PANEL (L1), 277V, 1 PHASE
- ⑯ TIE TO EXISTING CIRCUIT #3 PANEL (L1), 277V, 1 PHASE
- ⑰ BLUE LIGHT PHONE.
- ⑱ EXISTING ELECTRICAL HANDHOLE AND DUCTBANK SHALL BE RELOCATED BY THE ELECTRICAL CONTRACTOR.
- ⑲ EXISTING ELECTRICAL HANDHOLE TO BE RELOCATED BY ELECTRICAL CONTRACTOR.

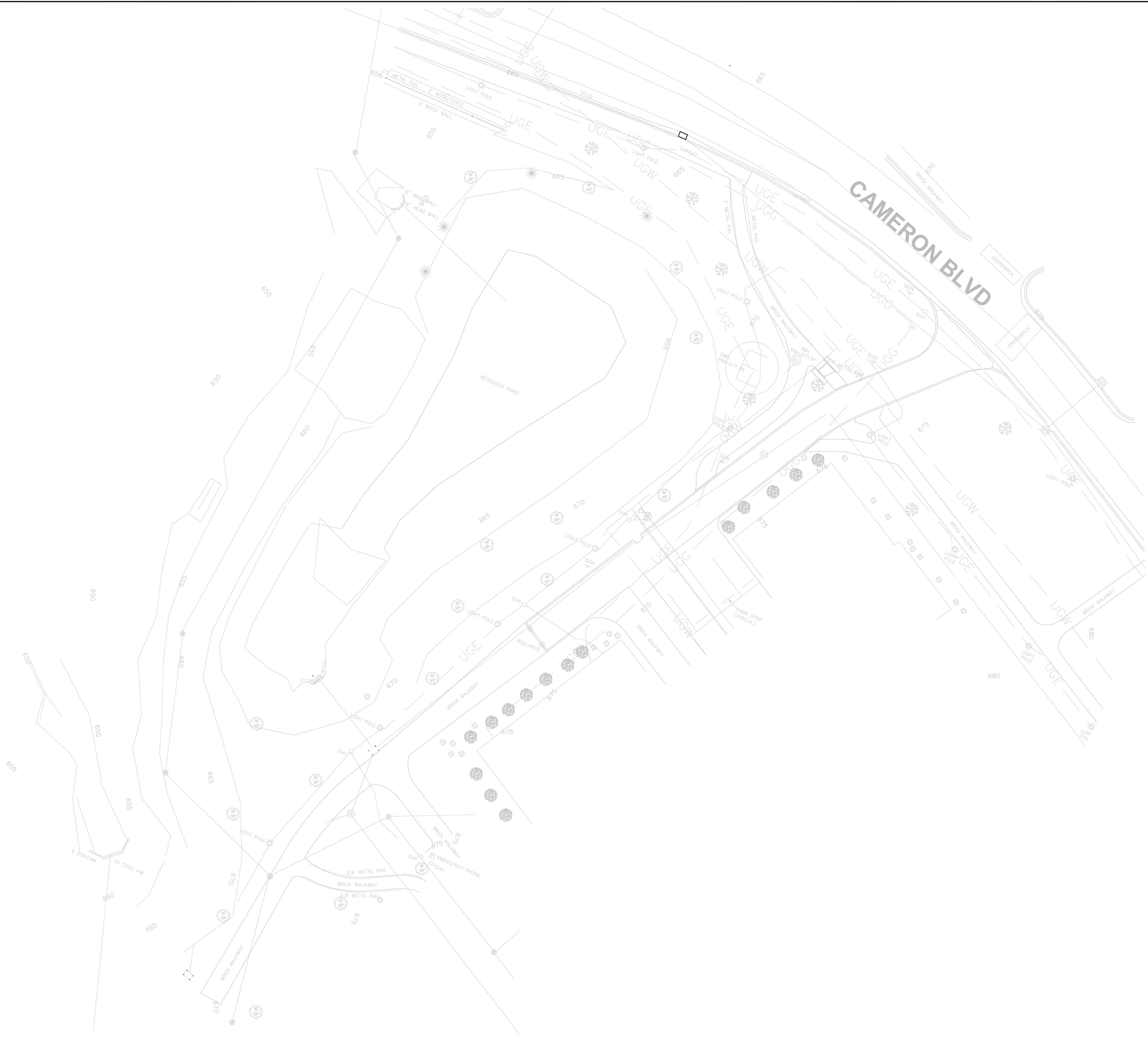

No.	REVISIONS	DATE	BY

CMTA
 8801 J.K. Moore Dr. Suite 200 Charlotte, NC 28242
 704.276.7072 cmta.com
 C-4556

BID SET

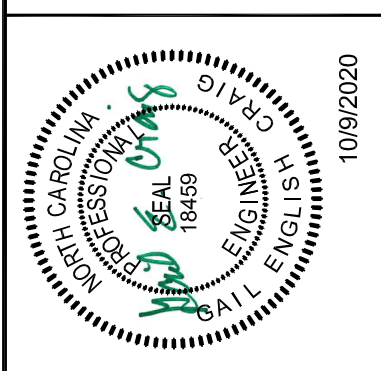

MC&L PROJECT	217,069
DATE	10/9/2020
SCALE	AS SHOWN
DESIGNED BY	JRM
DRAWN BY	GEJ
CHECKED BY	GEC

UNC CHARLOTTE
 9201 UNIVERSITY CITY BOULEVARD
 CHARLOTTE, NC 28223

ELECTRICAL PLANS

THE UNIVERSITY OF NORTH CAROLINA AT CHARLOTTE
 EAST VILLAGE
 INFRASTRUCTURE
 PROJECT ID #13-11004-02A



Know what's below.
 Call before you dig.