

UNC CHARLOTTE

9201 University City Blvd.
Charlotte, N.C. 28223

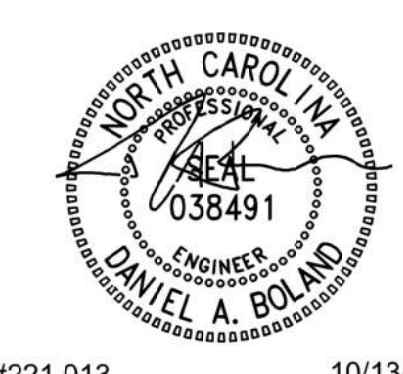

#221.013 10/13/2021

Project Title
UNCC HVAC, Plumbing and Electrical Repairs - McEniry Electrical & Plumbing Package
SCO ID # 20-22572-01A
PM: JOHN BOAL

08/04/2021	-	100% CD REVIEW SET	DAB
09/28/2021	-	BID SET	DAB
10/13/2021	1	ADDENDUM #2	DAB

Date:	Mark:	Description:	By:
-------	-------	--------------	-----

ELECTRICAL SITE PLAN - PHASE 1

Proj. No.: 221.013	Scale: AS NOTED
Date: 08/04/2021	
Drawn By: CADD	Checked: DAB
Sheet No.:	

E101

ALL DIMENSIONS AND CONDITIONS MUST BE CHECKED AND VERIFIED ON SITE BY THE CONTRACTOR AND SUB-CONTRACTORS. THE PROJECT MANAGER SHALL BE NOTIFIED IN WRITING OF ANY DISCREPANCIES PRIOR TO PROCEEDING WITH THE WORK.
© CMTA. - ALL RIGHTS RESERVED.

LEGEND

- ELEVATION LINE
- UNDERGROUND COMMUNICATION LINE
- UNDERGROUND ELECTRICAL LINE
- UNDERGROUND GAS LINE
- UNDERGROUND UNKNOWN LINE
- UNDERGROUND WATER LINE
- UNDERGROUND SANITARY LINE
- ⊗ LP LIGHT POLE

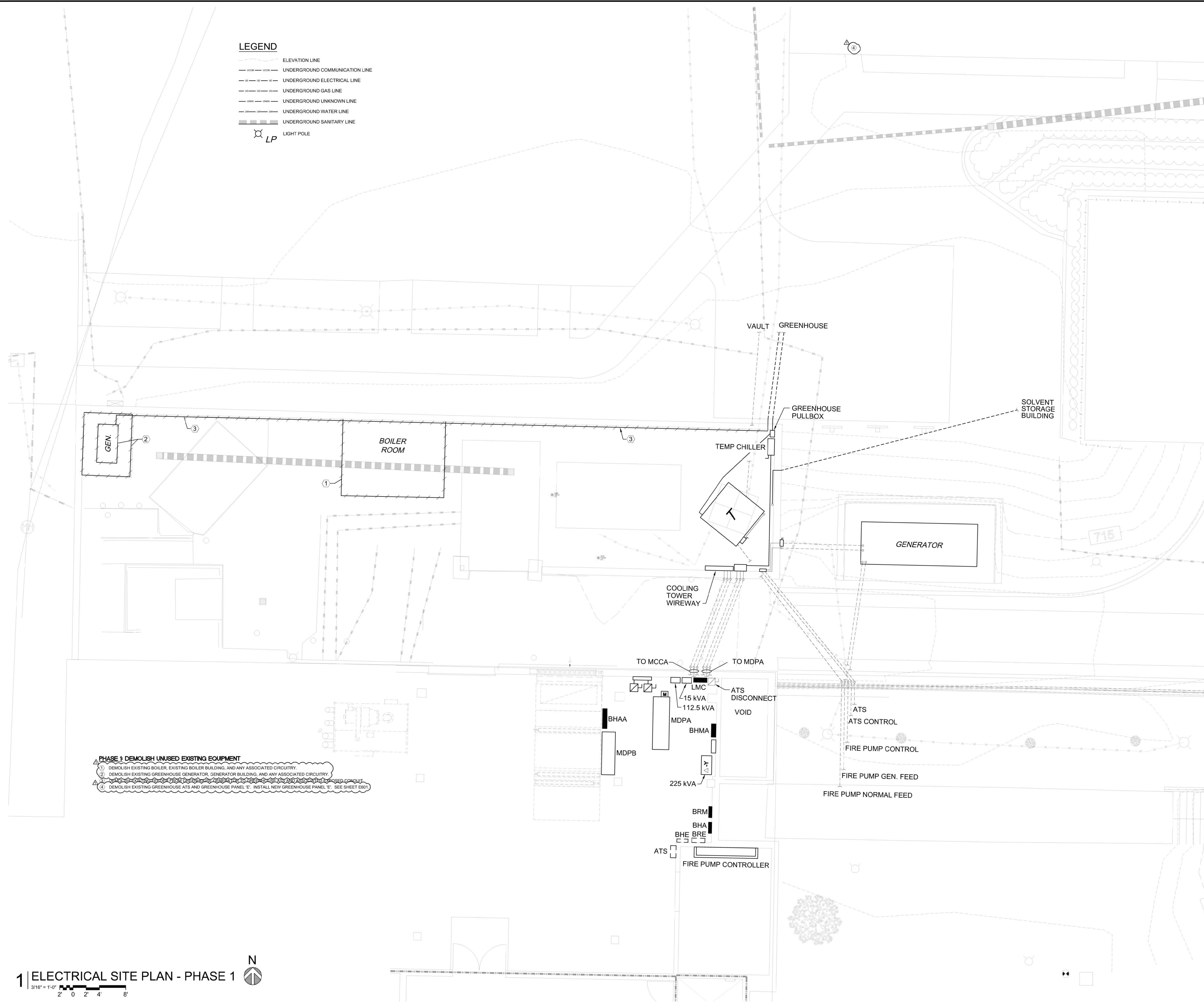

- PHASE 1 DEMOLISH UNUSED EXISTING EQUIPMENT**
- 1 DEMOLISH EXISTING BOILER, EXISTING BOILER BUILDING, AND ANY ASSOCIATED CIRCUITRY.
 - 2 DEMOLISH EXISTING GREENHOUSE GENERATOR, GENERATOR BUILDING, AND ANY ASSOCIATED CIRCUITRY.
 - 3 DEMOLISH EXISTING GREENHOUSE ATSS AND GREENHOUSE PANEL 'E' AND ASSOCIATED CONDUIT.
 - 4 DEMOLISH EXISTING GREENHOUSE ATSS AND GREENHOUSE PANEL 'E'. INSTALL NEW GREENHOUSE PANEL 'E'. SEE SHEET E901.

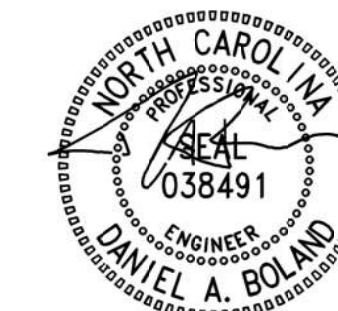

#221.013 10/13/2021

Project Title
UNCC HVAC, Plumbing and Electrical Repairs - McEniry Electrical & Plumbing Package
 SCO ID # 20-22572-01A
 PM: JOHN BOAL

08/04/2021	-	100% CD REVIEW SET	DAB
09/28/2021	-	BID SET	DAB
10/13/2021	1	ADDENDUM #2	DAB

Date:	Mark:	Description:	By:
-------	-------	--------------	-----

ELECTRICAL SITE PLAN - PHASE 3

Proj. No.: 221.013	Scale: AS NOTED
Date: 08/04/2021	
Drawn By: CADD	Checked: DAB
Sheet No.:	

E103

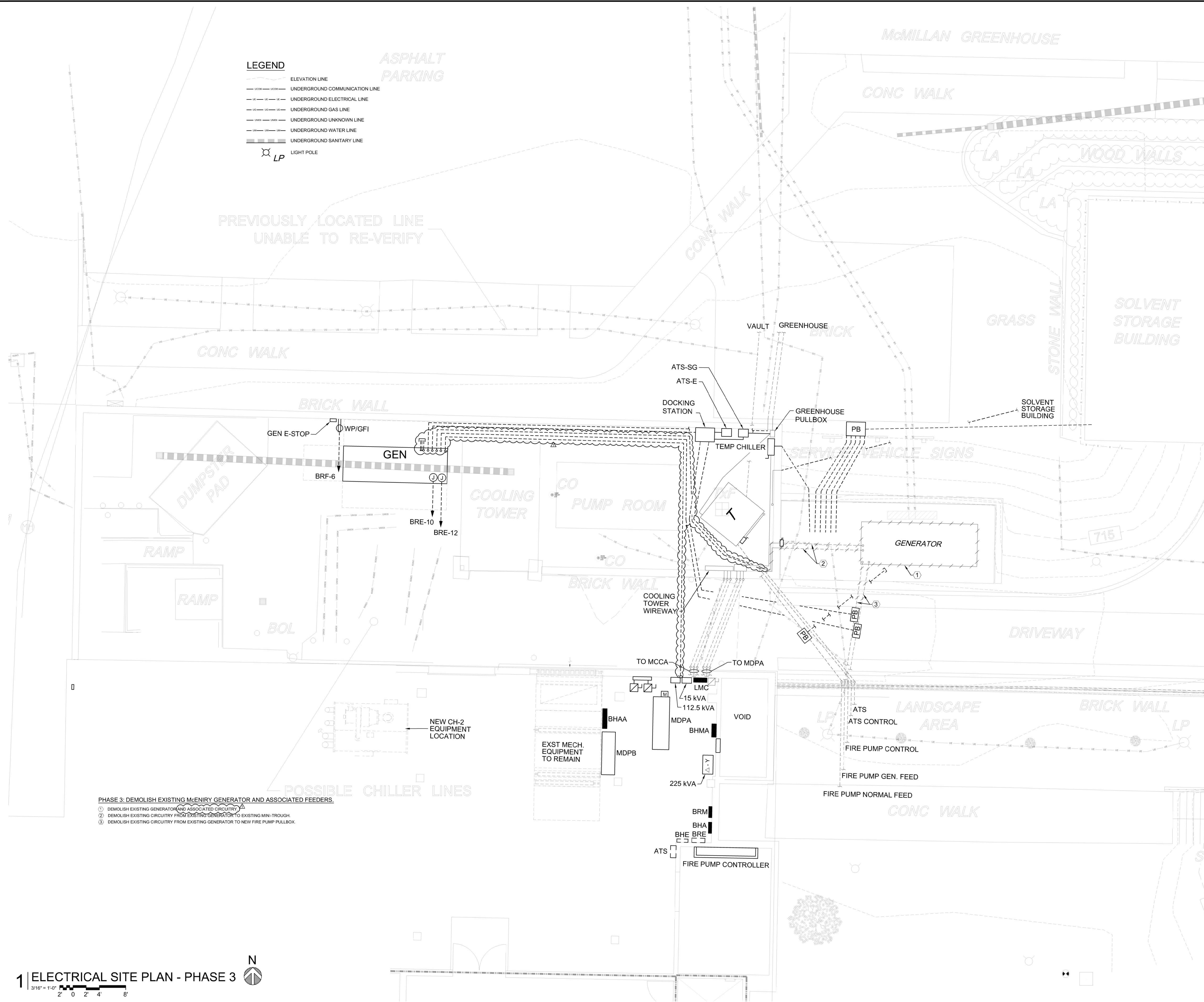

LEGEND

- ELEVATION LINE
- UNDERGROUND COMMUNICATION LINE
- UNDERGROUND ELECTRICAL LINE
- UNDERGROUND GAS LINE
- UNDERGROUND UNKNOWN LINE
- UNDERGROUND WATER LINE
- UNDERGROUND SANITARY LINE
- ⊗ LP LIGHT POLE

PHASE 3: DEMOLISH EXISTING McENIRY GENERATOR AND ASSOCIATED FEEDERS.

- ① DEMOLISH EXISTING GENERATOR AND ASSOCIATED CIRCUITRY
- ② DEMOLISH EXISTING CIRCUITRY FROM EXISTING GENERATOR TO EXISTING MINI-TROUGH.
- ③ DEMOLISH EXISTING CIRCUITRY FROM EXISTING GENERATOR TO NEW FIRE PUMP PULLBOX.

1 ELECTRICAL SITE PLAN - PHASE 3

3/16" = 1'-0"
 2' 0' 2' 4' 8'





#221.013 10/13/2021

Project Title
UNCC HVAC, Plumbing and Electrical Repairs - McEniry Electrical & Plumbing Package
 SCO ID # 20-22572-01A
 PM: JOHN BOAL

08/04/2021	-	100% CD REVIEW SET	DAB
09/28/2021	-	BID SET	DAB
10/13/2021	1	ADDENDUM #2	DAB

Date:	Mark:	Description:	By:
-------	-------	--------------	-----

ELECTRICAL SITE PLAN - PHASE 4

Proj. No.: 221.013	Scale: AS NOTED
Date: 08/04/2021	Checked: DAB
Drawn By: CADD	Sheet No.:

E104

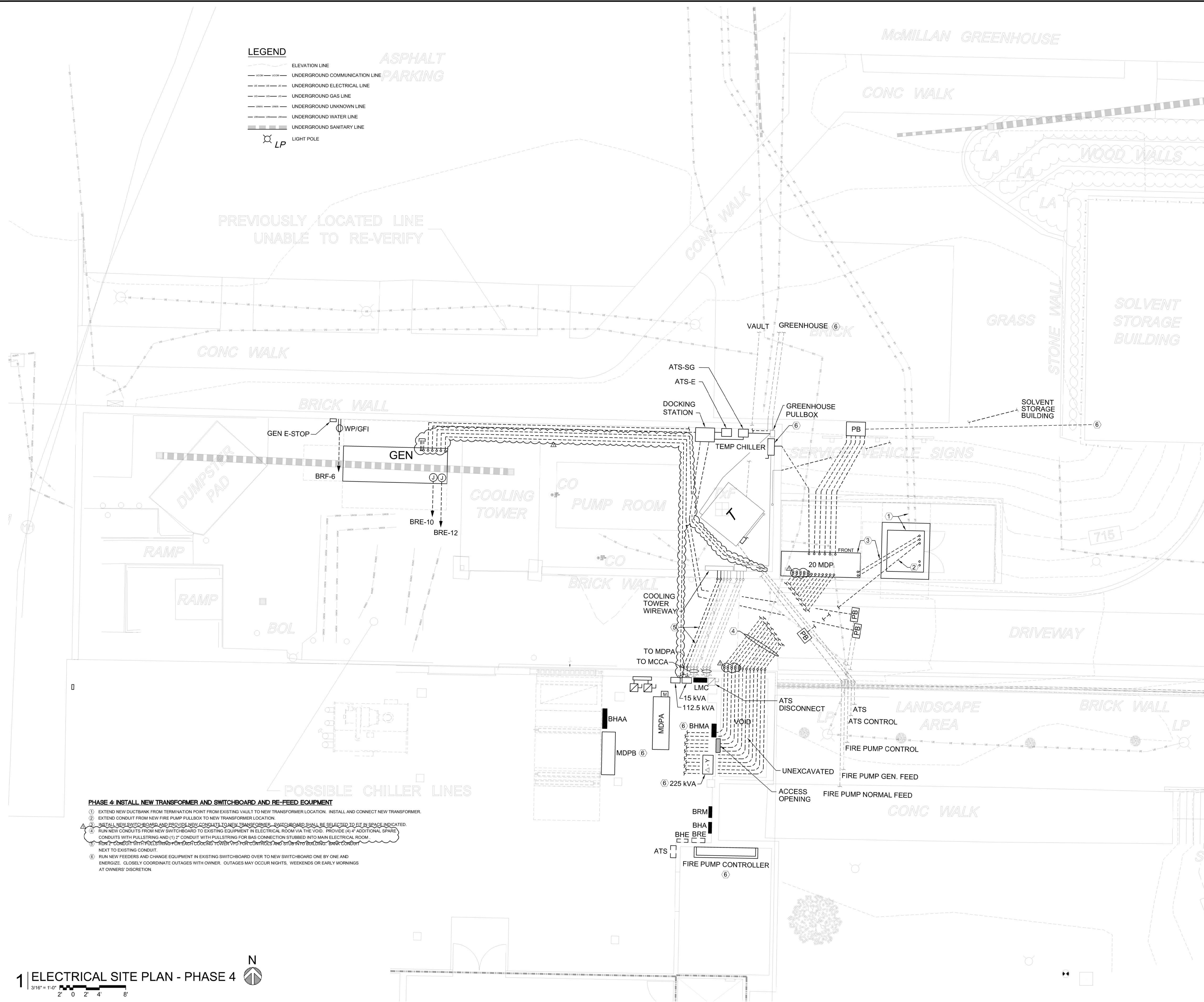

LEGEND

- ELEVATION LINE
- UNDERGROUND COMMUNICATION LINE
- UNDERGROUND ELECTRICAL LINE
- UNDERGROUND GAS LINE
- UNDERGROUND UNKNOWN LINE
- UNDERGROUND WATER LINE
- UNDERGROUND SANITARY LINE
- ⊗ LP LIGHT POLE

- PHASE 4: INSTALL NEW TRANSFORMER AND SWITCHBOARD AND RE-FEED EQUIPMENT**
- 1) EXTEND NEW DUCTBANK FROM TERMINATION POINT FROM EXISTING VAULT TO NEW TRANSFORMER LOCATION. INSTALL AND CONNECT NEW TRANSFORMER.
 - 2) EXTEND CONDUIT FROM NEW FIRE PUMP PULLBOX TO NEW TRANSFORMER LOCATION.
 - 3) INSTALL NEW SWITCHBOARD AND PROVIDE NEW CONDUITS TO NEW TRANSFORMER. SWITCHBOARD SHALL BE SELECTED TO FIT IN SPACE INDICATED.
 - 4) RUN NEW CONDUITS FROM NEW SWITCHBOARD TO EXISTING EQUIPMENT IN ELECTRICAL ROOM VIA THE VOID. PROVIDE (4) 4" ADDITIONAL SPARE CONDUITS WITH PULLSTRING AND (1) 2" CONDUIT WITH PULLSTRING FOR BAS CONNECTION STUBBED INTO MAIN ELECTRICAL ROOM.
 - 5) RUN 2" CONDUIT WITH PULLSTRING FOR EXISTING COOLING TOWER AND FOR CONTRACTORS AND OTHER BUILDING. DRAW CONDUIT NEXT TO EXISTING CONDUIT.
 - 6) RUN NEW FEEDERS AND CHANGE EQUIPMENT IN EXISTING SWITCHBOARD OVER TO NEW SWITCHBOARD ONE BY ONE AND ENERGIZE. CLOSELY COORDINATE OUTAGES WITH OWNER. OUTAGES MAY OCCUR NIGHTS, WEEKENDS OR EARLY MORNINGS AT OWNERS' DISCRETION.