

0004 03 INT 31,078.87
0004 03 EXT 32,022.55

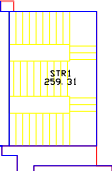

300
24962.28

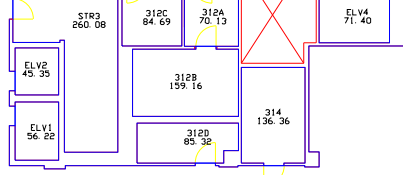

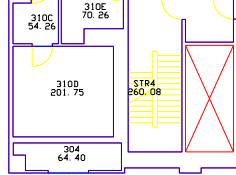
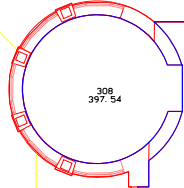
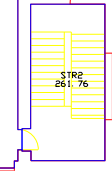
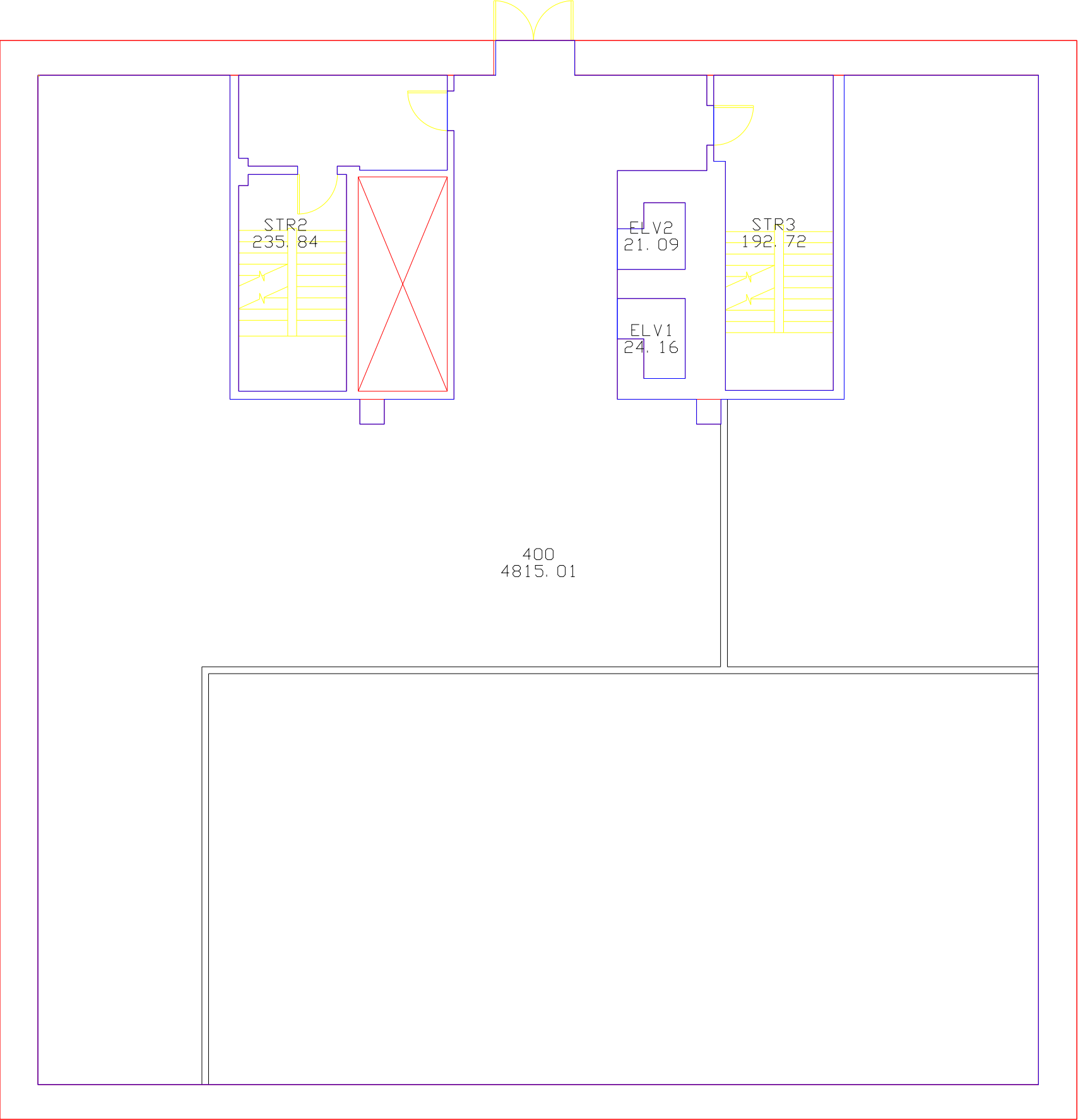

0004
04
INT
5,576.11

0004
04
EXT
6,398.34

400
4815.01

STR2
235.84

ELV2
21.09

STR3
192.72

ELV1
24.16

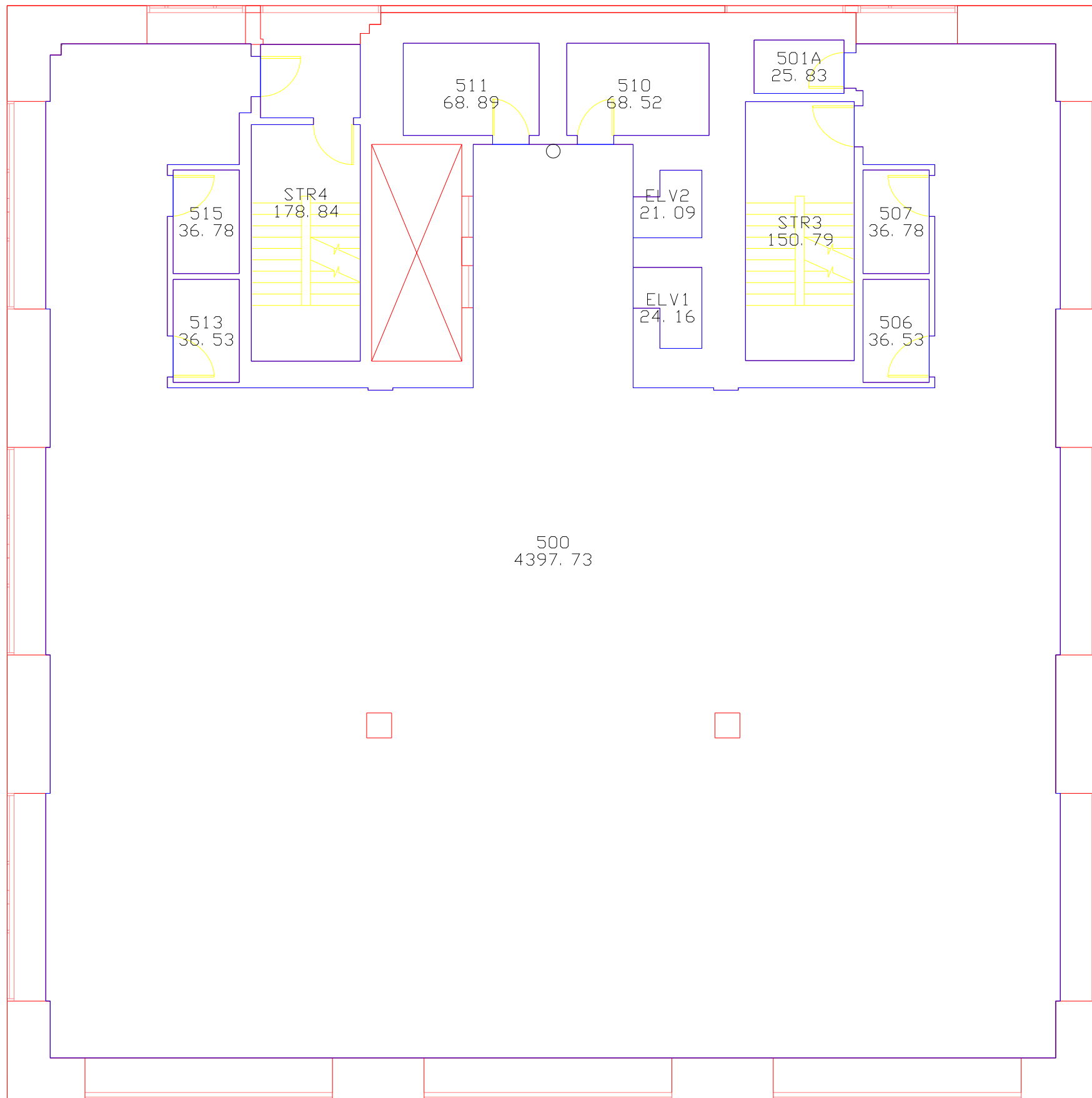

0004
05
INT
5,575.17

0004
05
EXT
6,399.17

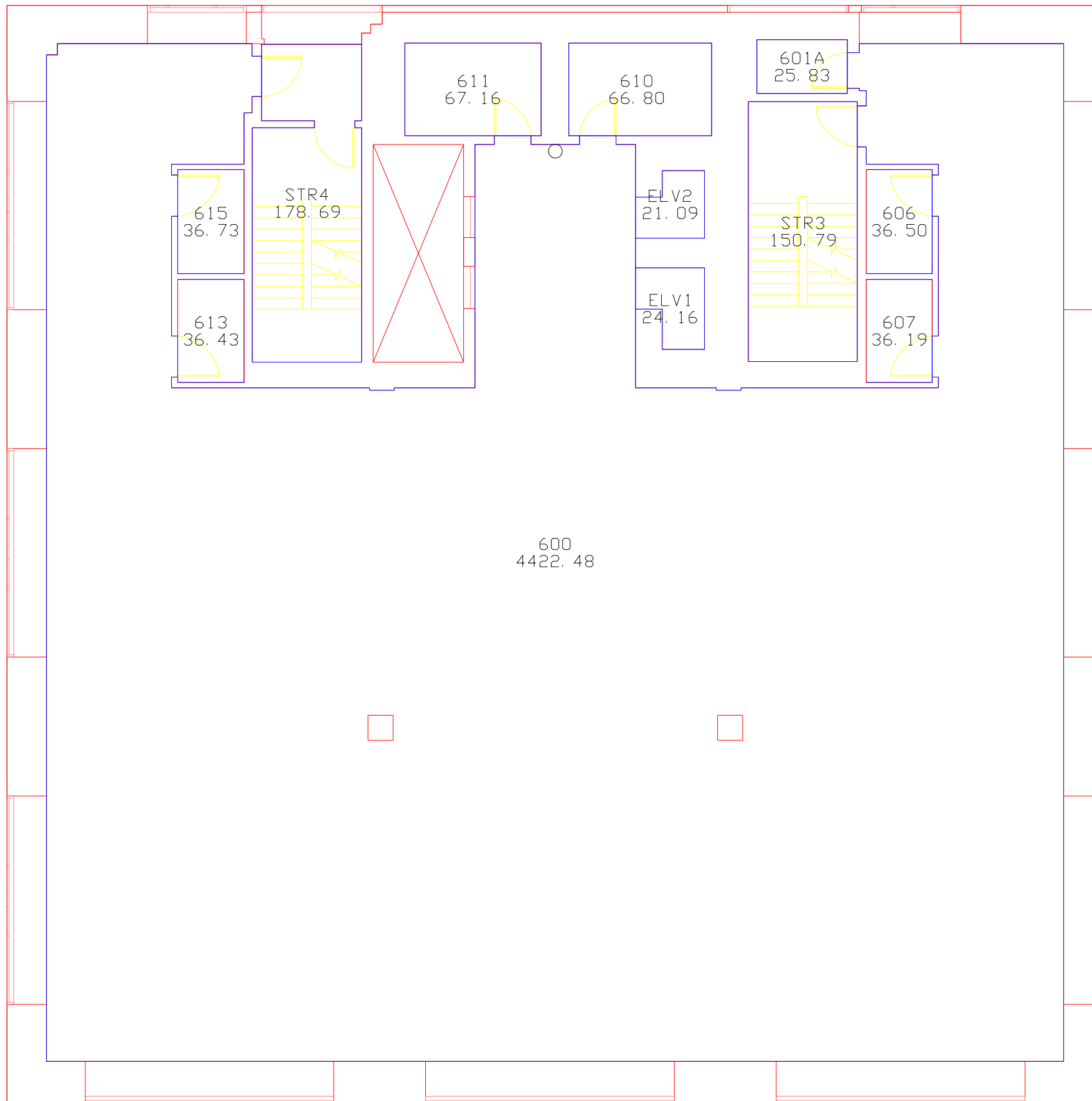

0004
06
INT
5,605.10

0004
06
EXT
6,400.00

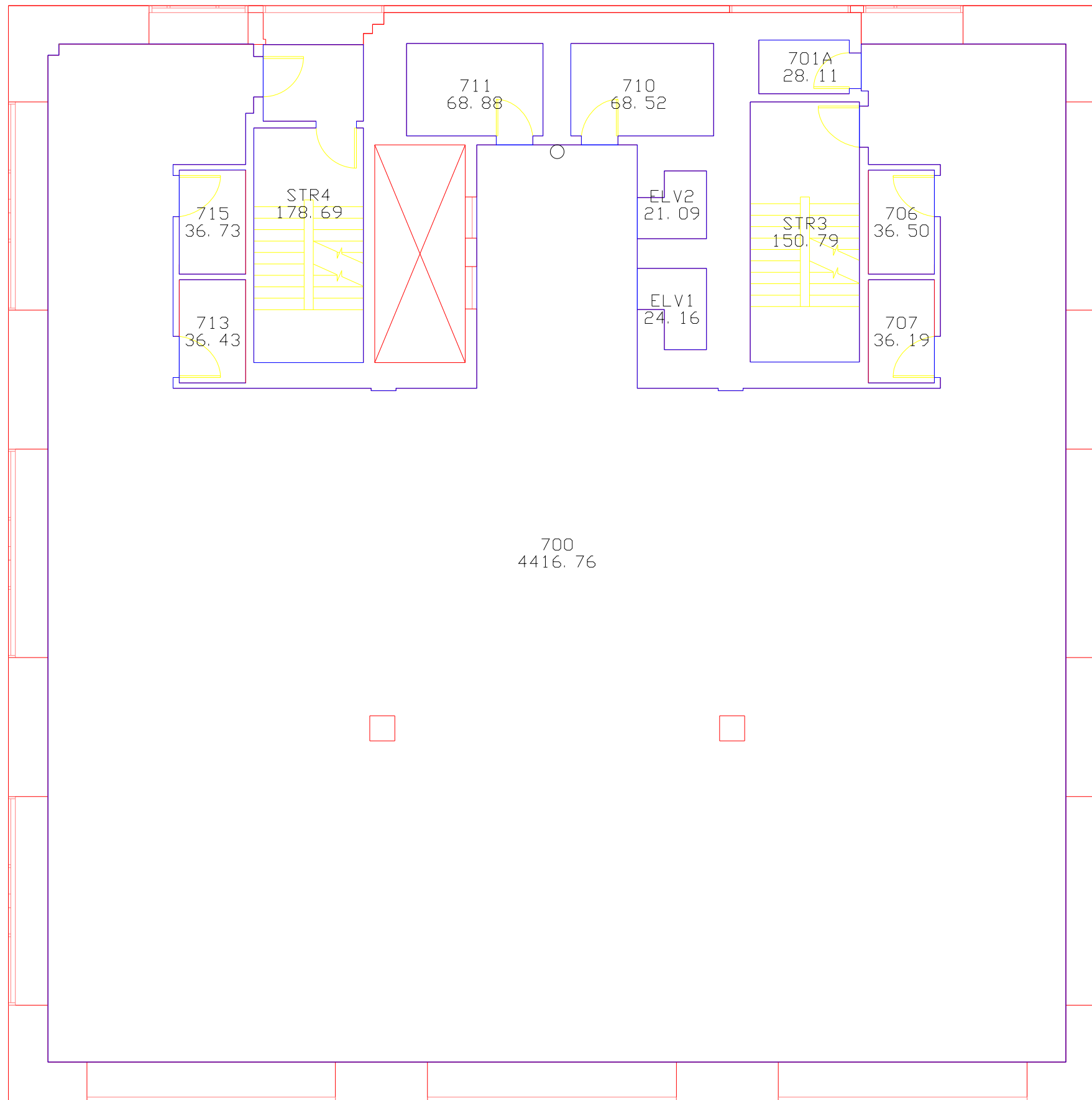

0004
07
INT
5,587.93

0004
07
EXT
6,400.00

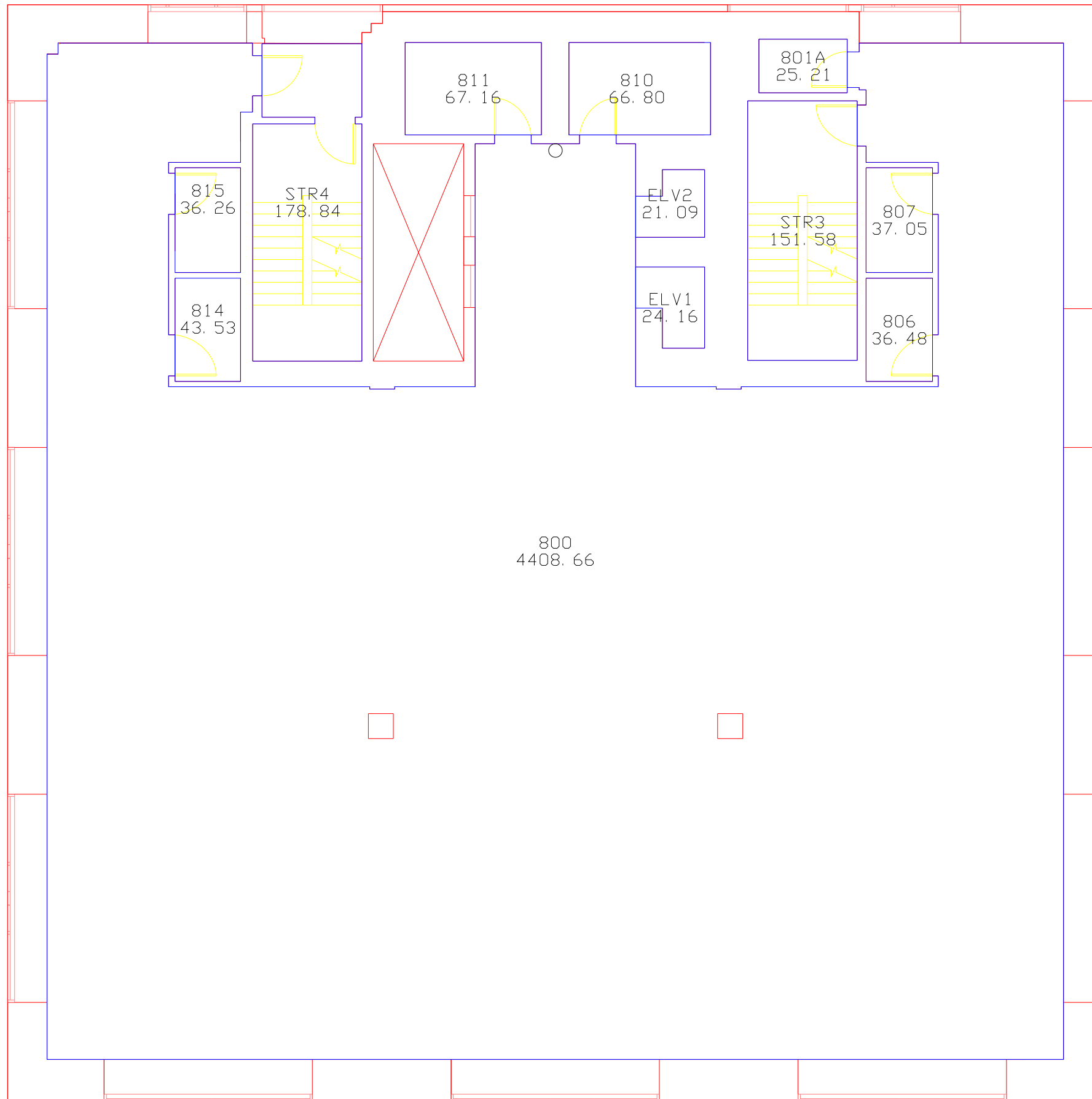

0004
08
INT
5,588.26

0004
08
EXT
6,400.00

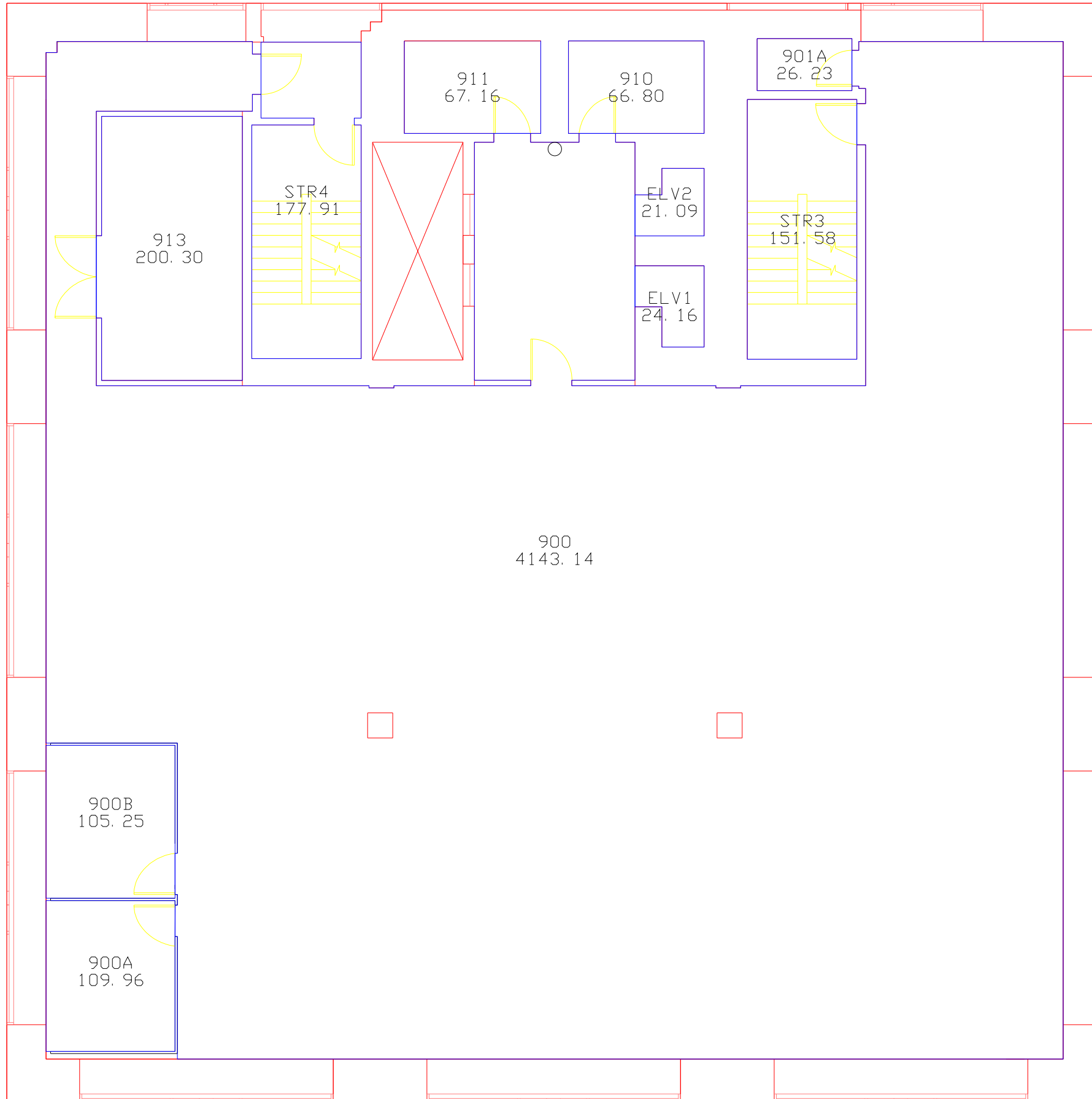

0004
09
INT
5,588.46

0004
09
EXT
6,398.34

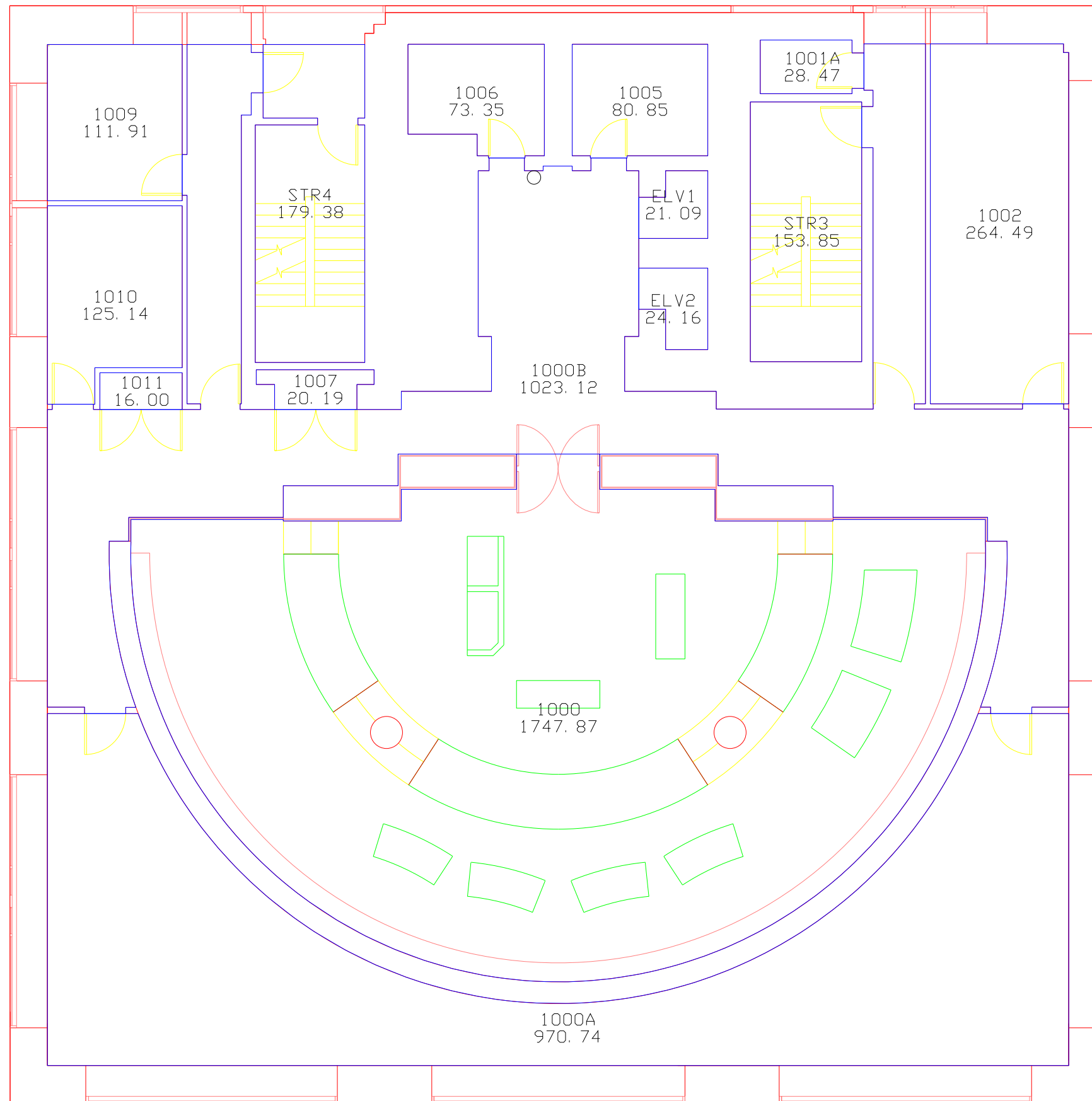

0004
 10
 INT
 5,627.14

0004
 10
 EXT
 6,399.17

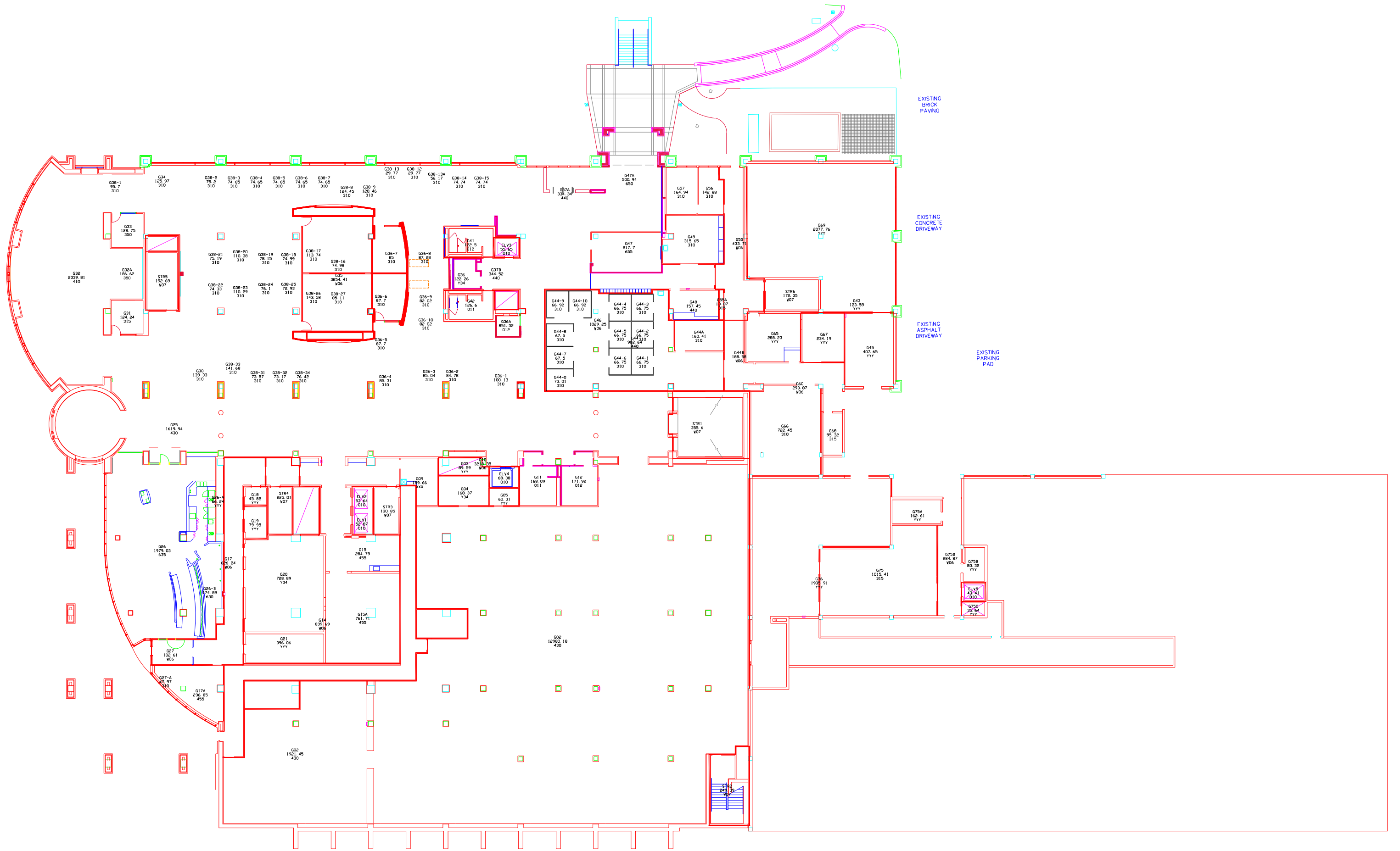

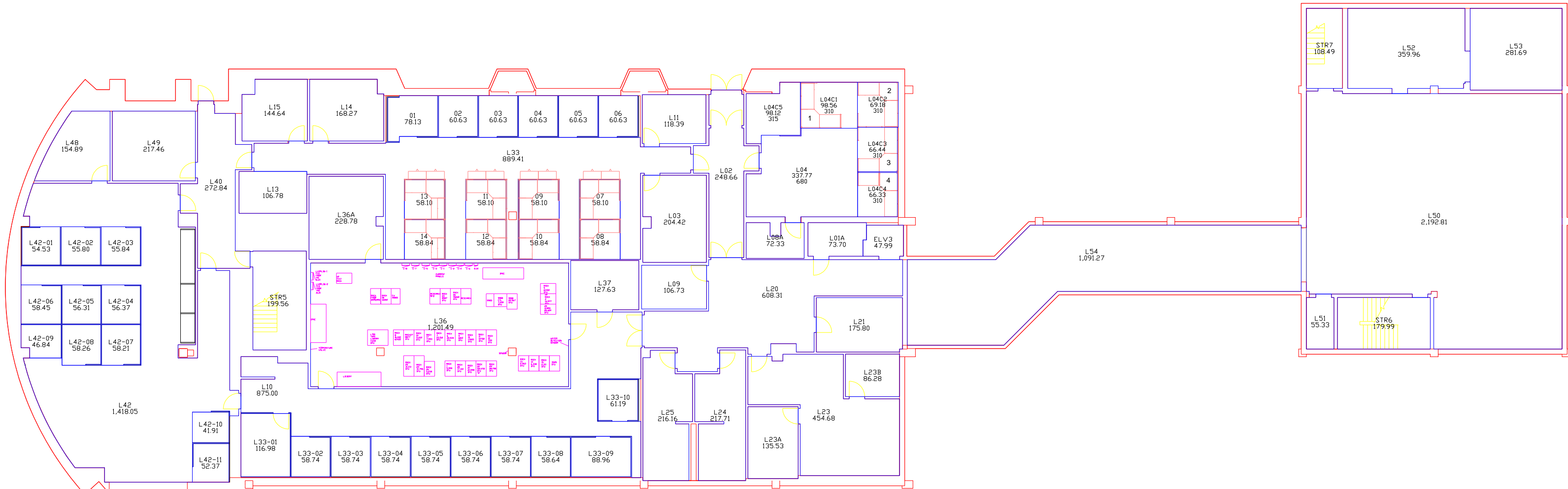

0004
L00
EXT
18,691.40

0004
L00
INT
17,359.34

