



Know what's below.
Call before you dig.

CONTRACTOR SHALL NOTIFY "NC811" (811) OR (1-800-632-4949) AT LEAST 3 FULL BUSINESS DAYS PRIOR TO BEGINNING CONSTRUCTION OR EXCAVATION TO HAVE EXISTING UTILITIES LOCATED. CONTRACTOR SHALL CONTACT ANY LOCAL UTILITIES THAT PROVIDE THEIR OWN LOCATOR SERVICES INDEPENDENT OF "NC811". REPORT ANY DISCREPANCIES TO THE ENGINEER IMMEDIATELY.

CONTRACTOR TO COORDINATE UNIVERSITY OWNED UTILITY LOCATES THROUGH THE CAPITAL PROJECTS CONSTRUCTION MANAGER.

DEMOLITION NOTES:

1. THE CONTRACTOR SHALL FIELD VERIFY AND LOCATE ALL EXISTING UTILITIES ON SITE PRIOR TO DEMOLITION. COORDINATE LOCATES OF UNIVERSITY UTILITIES WITH THE UNIVERSITY CONSTRUCTION MANAGER AT LEAST 96 HOURS PRIOR TO DEMOLITION ACTIVITIES.
2. THE CONTRACTOR SHALL PERFORM DEMOLITION ACTIVITIES AS NOTED AND SHOWN ON THESE PLANS AND AS DIRECTED BY THE UNIVERSITY CONSTRUCTION MANAGER.
3. IT WILL BE THE CONTRACTOR'S RESPONSIBILITY TO OBTAIN ANY PERMITS AND PAY FEES REQUIRED FOR DEMOLITION AND HAUL-OFF FROM THE APPROPRIATE AUTHORITIES. THESE FEES ARE TO BE INCLUDED WITH THE BID.
4. THE CONTRACTOR SHALL PREPARE ALL DOCUMENTS AND ACQUIRE APPROPRIATE PERMITS AS REQUIRED PRIOR TO THE COMMENCEMENT OF DEMOLITION.
5. THE DEMOLITION PLAN IS INTENDED TO DEPICT GENERAL DEMOLITION AND UTILITY WORK. IT IS NOT INTENDED TO IDENTIFY EACH ELEMENT OF DEMOLITION OR RELOCATION. CONTRACTOR SHALL COORDINATE WITH THE UNIVERSITY CONSTRUCTION MANAGER AND APPROPRIATE UTILITY COMPANY PRIOR TO WORK.
6. REMOVE AND DISPOSE OF ANY SIDEWALK, CONCRETE STOOPS, FENCES, STAIRS, WALLS, FOUNDATIONS, CONDUITS, LIGHT POLE BASES, DEBRIS AND RUBBISH REQUIRING REMOVAL FROM THE WORK AREA IN AN APPROVED LANDFILL.
7. REMOVE AND/OR PLUG EXISTING UTILITIES SUCH AS SANITARY SEWER, WATER, GAS, ELECTRIC, AND TELEPHONE AS SHOWN. THE CONTRACTOR IS RESPONSIBLE FOR CONTACTING EACH UTILITY COMPANY TO COORDINATE REMOVAL OF ALL UTILITIES AND FOR DETERMINING HORIZONTAL AND VERTICAL LOCATIONS OF UTILITIES PRIOR TO COMMENCING WORK.
8. THE CONTRACTOR SHALL CUT AND PLUG, OR ARRANGE FOR THE APPROPRIATE UTILITY COMPANY TO CUT AND PLUG ALL SERVICE PIPING AT THE MAIN, AS REQUIRED, OR AS OTHERWISE NOTED. ALL SERVICES MAY NOT BE SHOWN ON THE PLAN. THE CONTRACTOR SHALL INVESTIGATE THE SITE PRIOR TO BIDDING TO DETERMINE THE EXTENT OF SERVICE PIPING TO BE REMOVED, CUT OR PLUGGED.
9. INSTALL ALL EROSION AND SEDIMENT CONTROL DEVICES AND TREE PROTECTION PRIOR TO BEGINNING DEMOLITION WORK.
10. THE CONTRACTOR IS RESPONSIBLE FOR THE PROTECTION OF ALL UTILITIES TO REMAIN IN PLACE.
11. THE CONTRACTOR SHALL TAKE ALL PRECAUTIONS TO AVOID UNNECESSARY DAMAGE TO EXISTING ADJACENT SIDEWALKS.
12. FINISH SURFACES TO BE REMOVED OR DEMOLISHED SHALL BE CUT ALONG LINES OF JOINTS WHICH WILL PERMIT A NEAT SURFACE WHEN RESTORED.
13. ALL EXISTING ITEMS TO REMAIN WHICH ARE DAMAGED DURING CONSTRUCTION SHALL BE RESTORED TO ITS ORIGINAL CONDITION AT THE SOLE EXPENSE OF THE CONTRACTOR.
14. THE CONTRACTOR SHALL MAINTAIN ALL UTILITY SERVICES TO THE ADJOINING BUILDINGS DURING THE DEMOLITION PROCESS.
15. DO NOT INTERRUPT EXISTING UTILITIES SERVING FACILITIES OCCUPIED AND USED BY THE UNIVERSITY OR OTHERS. ANY INTERRUPTIONS IN SERVICE MUST BE AUTHORIZED IN WRITING BY THE UNIVERSITY CONSTRUCTION MANAGER AND THE LOCAL UTILITY CONTACT. INTERRUPTIONS SHALL ONLY OCCUR AFTER ACCEPTABLE TEMPORARY SERVICE HAS BEEN PROVIDED.
16. IF ANY UNCHARTED OR INCORRECTLY CHARTED EXISTING PIPING OR OTHER UTILITY BE UNCOVERED DURING EXCAVATION, CONSULT THE DESIGNER IMMEDIATELY FOR DIRECTIONS BEFORE PROCEEDING FURTHER WITH WORK IN THIS AREA.
17. ASBESTOS OR HAZARDOUS MATERIAL IF FOUND ON SITE, SHALL BE REMOVED BY A LICENSED HAZARDOUS MATERIAL CONTRACTOR, AND DISPOSED OF IN A LAWFUL MANNER.
18. IN ACCORDANCE WITH 40 CFR, PART 61, SUBPART M, A THOROUGH INSPECTION SHALL BE CONDUCTED FOR ASBESTOS-CONTAINING MATERIALS, PRIOR TO CONDUCTING A RENOVATION OR DEMOLITION ACTIVITY OF AN EXISTING STRUCTURE. THE ASBESTOS INSPECTION MUST BE CONDUCTED BY A NORTH CAROLINA ACCREDITED ASBESTOS INSPECTOR. ALL REGULATED AND/OR FRIABLE ASBESTOS-CONTAINING MATERIALS IDENTIFIED DURING THE SURVEY, WHICH WILL BE DISTURBED, MUST BE PROPERLY REMOVED BY ACCREDITED INDIVIDUALS BEFORE BEGINNING THE RENOVATION OR DEMOLITION ACTIVITY. IF REGULATED AND/OR FRIABLE ASBESTOS CONTAINING MATERIALS TO BE REMOVED EXCEED 160 SQUARE FEET, 260 LINEAR FEET OR 35 CUBIC FEET, A PERMIT SHALL BE APPLIED FOR THROUGH THE NORTH CAROLINA DEPARTMENT OF HEALTH AND HUMAN SERVICES.
19. ALL MATERIAL TO BE DEMOLISHED SHALL BE REMOVED FROM THE SITE AND DISPOSED OF AT A PERMITTED SITE IN ACCORDANCE WITH ALL LOCAL, STATE AND FEDERAL LAWS.
20. TREE PROTECTION TO BE INSTALLED, PER CLOSM 40.02 FOR THE EXISTING TREES IDENTIFIED TO REMAIN. SEE SHEET EC-3 FOR THE PROTECTION DETAIL.
21. ALL 2"-3/4" PAVERS REMOVED DURING DEMOLITION SHALL BE STOCKPILED FOR REUSE IN THE FINAL HARDSCAPE PLAN.
22. ALL FOOTING EXCAVATIONS AND SUBGRADES OF PROPOSED PAVER WALKWAYS SHALL BE INSPECTED AND TESTED BY THE ON-SITE GEOTECHNICAL ENGINEER. ANY UNDOCUMENTED FILL MATERIAL, ORGANIC MATERIAL, PLASTIC CLAYS, ETC. DEEMED UNSATISFACTORY FOR SUBGRADE BY THE GEOTECHNICAL ENGINEER, SHALL BE UNDERCUT AND REPLACED WITH SUITABLE MATERIAL AND RE-INSPECTED BY THE GEOTECHNICAL ENGINEER. NO ADDITIONAL PAYMENT SHALL BE MADE FOR REQUIRED UNDERCUT AND DISPOSAL OF UNDERCUT MATERIAL.
23. CONTRACTOR IS RESPONSIBLE FOR THE DEMOLITION OF TREES MARKED TO BE REMOVED. TREES MARKED TO BE RELOCATED ARE THE RESPONSIBILITY OF UNC CHARLOTTE GROUNDS DEPARTMENT. CONTRACTOR SHALL COORDINATE WITH THE UNIVERSITY CONSTRUCTION MANAGER REGARDING TREE RELOCATION COORDINATION EFFORTS.
24. NEAR SURFACE ROCK SHALL BE REMOVED AS NECESSARY AND AS DIRECTED BY THE GEOTECHNICAL ENGINEER BELOW PROPOSED FOOTINGS. BLASTING SHALL NOT BE ALLOWED WITHOUT PRIOR CONSENT OF THE UNIVERSITY CONSTRUCTION MANAGER. NO ADDITIONAL PAYMENT SHALL BE MADE FOR ROCK REMOVAL.
25. EXISTING SITE FURNISHINGS (BENCHES, TABLES, TRASH/RECYCLE RECEPTACLES, ETC.) ARE SCHEDULED FOR REUSE ON SITE. SITE FURNISHINGS SHALL BE REMOVED BY CONTRACTOR AND STORED AND PROTECTED FROM CONSTRUCTION ACTIVITY. COORDINATE REMOVAL/STORAGE WITH UNIVERSITY CONSTRUCTION MANAGER.
26. UNC CHARLOTTE INFORMATION TECHNOLOGY SERVICES (ITS) TO REMOVE ONLY THE PHONES FROM THE CODE BLUE EMERGENCY PHONES PRIOR TO DEMOLITION. THE REMAINDER OF THE CODE BLUE EQUIPMENT SHALL BE DEMOLISHED BY CONTRACTOR. COORDINATE PHONE REMOVAL WITH UNIVERSITY CONSTRUCTION MANAGER.

SEE INSET - THIS SHEET

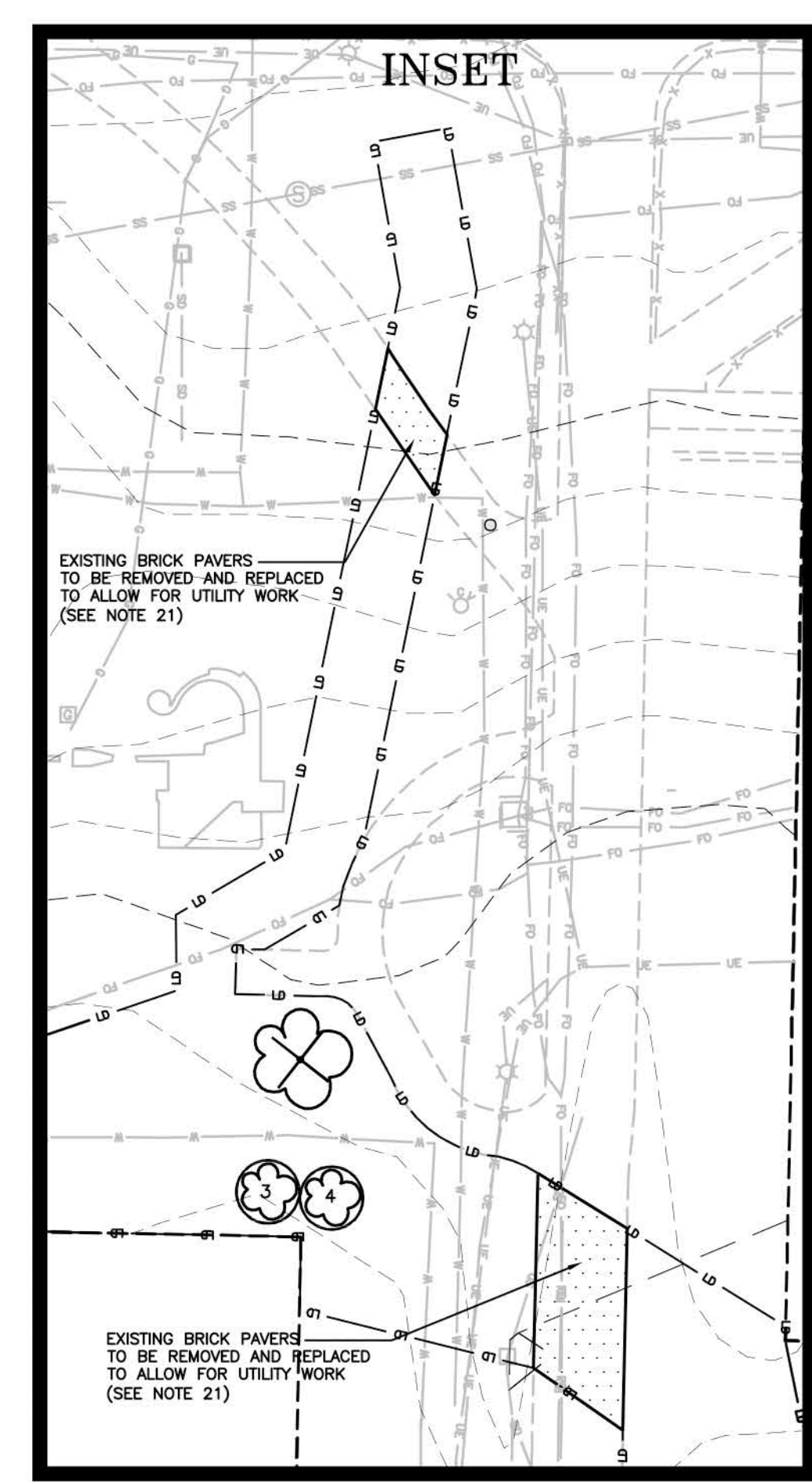
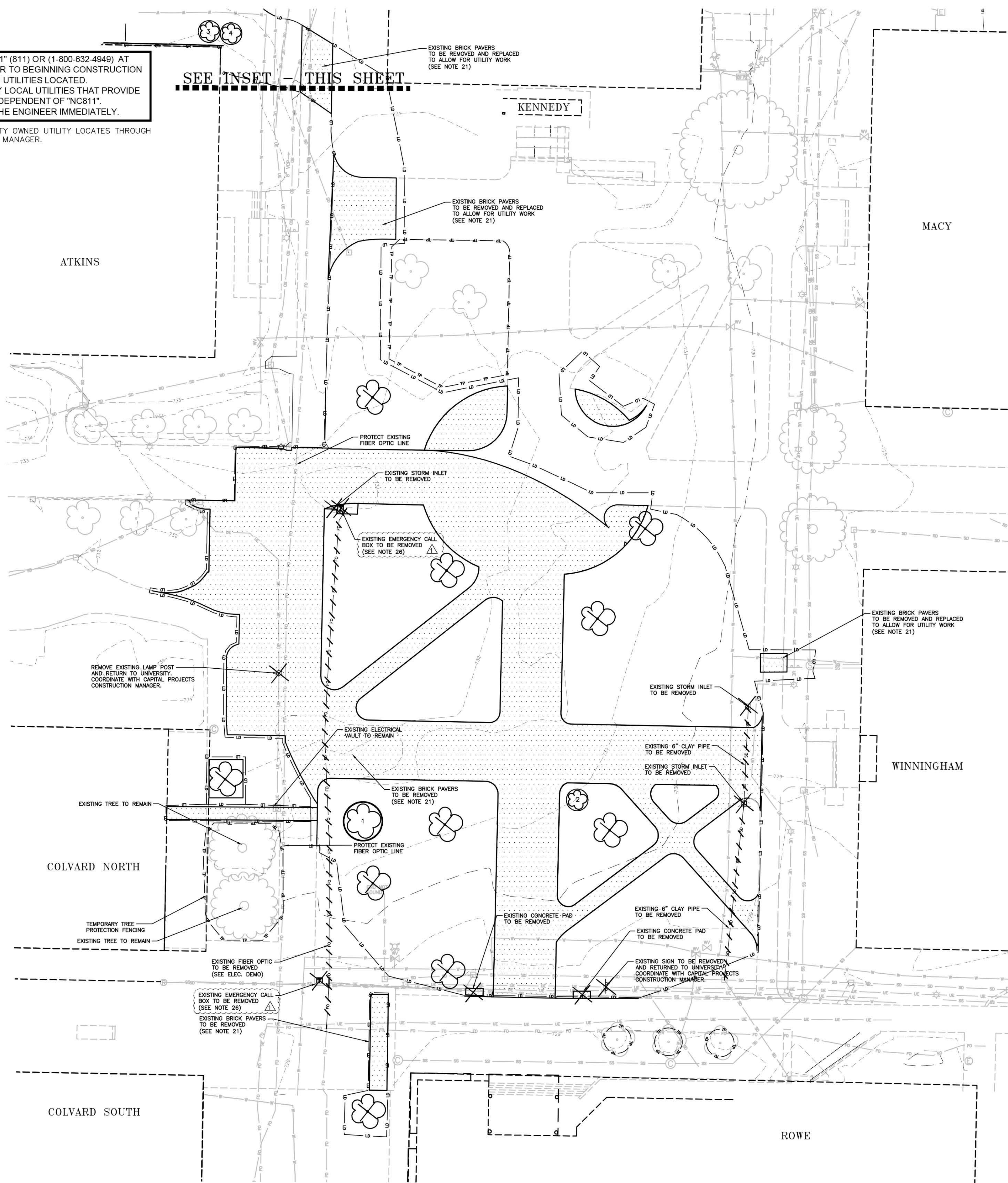

DEMOLITION LEGEND

	TREE OR OTHER VEGETATION TO BE REMOVED
	TREE TO BE SPADE AND RELOCATED. UNC CHARLOTTE GROUNDS DEPT. SHALL DETERMINE WHERE EACH TREE IS TO BE RELOCATED ON CAMPUS.
	HARDSCAPE FEATURE OR FURNISHING TO BE REMOVED
	UNDERGROUND UTILITY TO BE REMOVED
	AREA TO BE REMOVED (SIDEWALK, CURB AND GUTTER, STRUCTURES, ASPHALT, CONCRETE PAVERS, ETC. SEE NOTE 21)
	TREE PROTECTION
	LIMITS OF DISTURBANCE

NOTE: SEE PLAN FOR DETAILED DEMOLITION PROCEDURES, SEQUENCING AND SPECIFICATIONS.

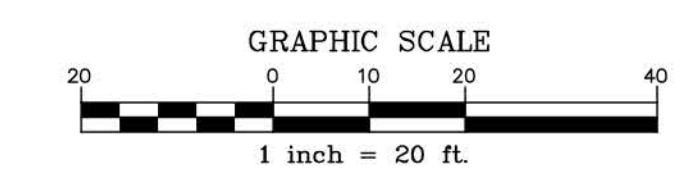

Y:\Projects\CLT\CLT-16010\Unica Construction Drawings\Current Drawings\UNIC16010-DM1.dwg, 8/22/2017 1:22:03 PM, Monafield, Kristen

THE JOHN R. MCADAMS COMPANY, INC.
3436 Torrington Way
Suite 110
Charlotte, North Carolina 28277
License No.: C-0283
(800) 793-5646 • McAdamsCo.com



REVISIONS:
2017-08-22 ADDITION #

OWNER:
UNIVERSITY OF NORTH CAROLINA AT CHARLOTTE
CHARLOTTE, NC 28223

BELK PLAZA REVITALIZATION
CONSTRUCTION DRAWINGS
CHARLOTTE, MECKLENBURG COUNTY, NORTH CAROLINA

PROJECT NO. CLT-16010
FILENAME: CLT16010-DM1
CHECKED BY: BGP
DRAWN BY: CSM
SCALE: 1"=20'
DATE: 2017-07-26
SHEET NO. C-2

DEMOLITION PLAN

1/1 MCADAMS

Y:\Projects\CLT\CLT-16010\Loca Construction Drawings\UNC16010-C6.dwg, 8/22/2017 11:22:37 AM, Mansfield, Kristen

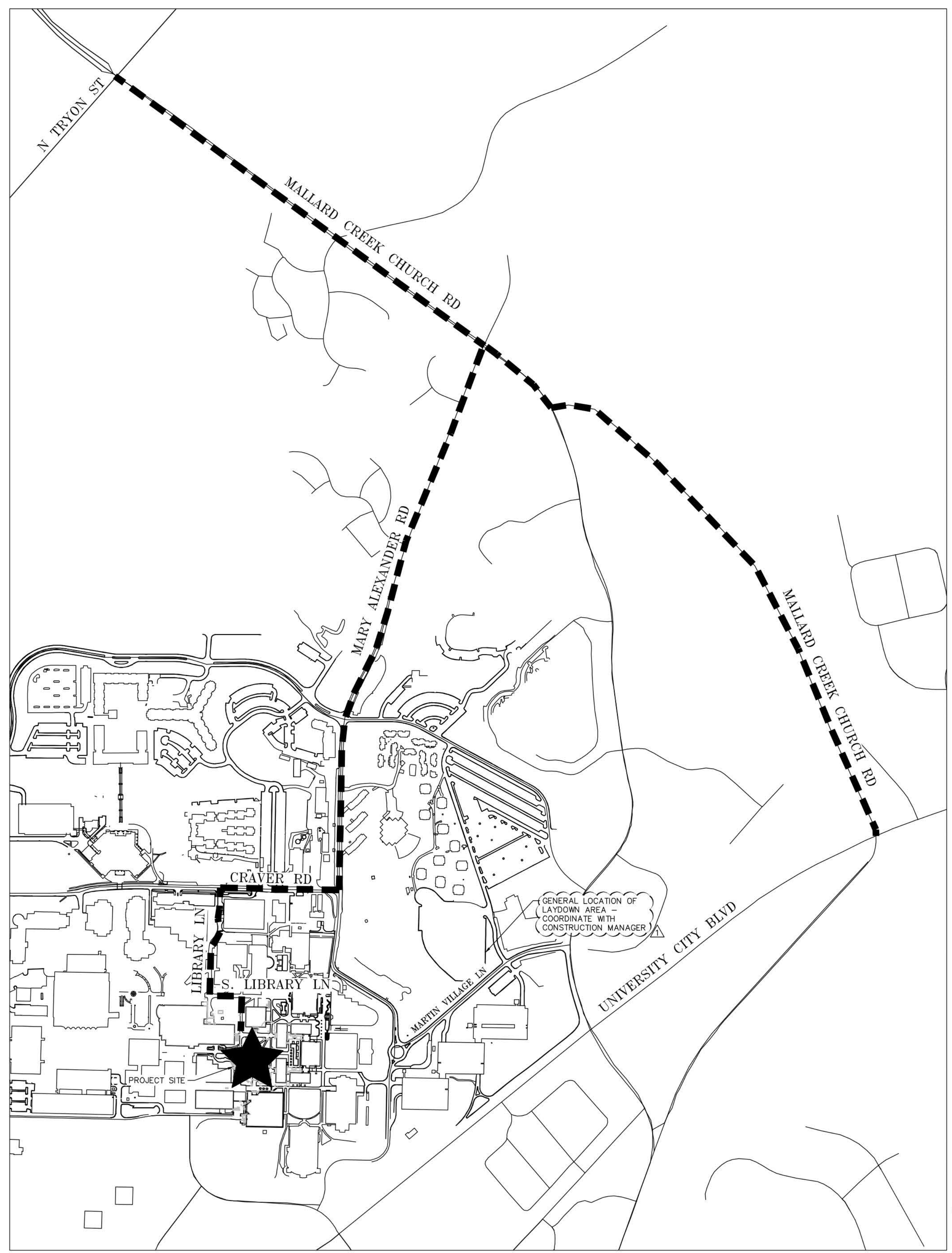

SITE ACCESS ROUTE

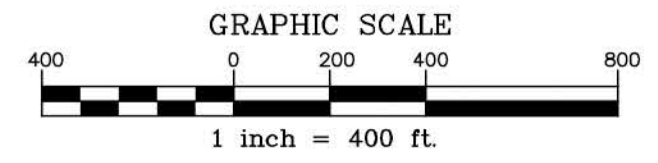

DATE PLOTTED (DD-MN-YY)



**Know what's below.
Call before you dig.**

CONTRACTOR SHALL NOTIFY "NC811" (811) OR (1-800-632-4949) AT LEAST 3 FULL BUSINESS DAYS PRIOR TO BEGINNING CONSTRUCTION OR EXCAVATION TO HAVE EXISTING UTILITIES LOCATED. CONTRACTOR SHALL CONTACT ANY LOCAL UTILITIES THAT PROVIDE THEIR OWN LOCATOR SERVICES INDEPENDENT OF "NC811". REPORT ANY DISCREPANCIES TO THE ENGINEER IMMEDIATELY.

CONTRACTOR TO COORDINATE UNIVERSITY OWNED UTILITY LOCATES THROUGH THE CAPITAL PROJECTS CONSTRUCTION MANAGER.

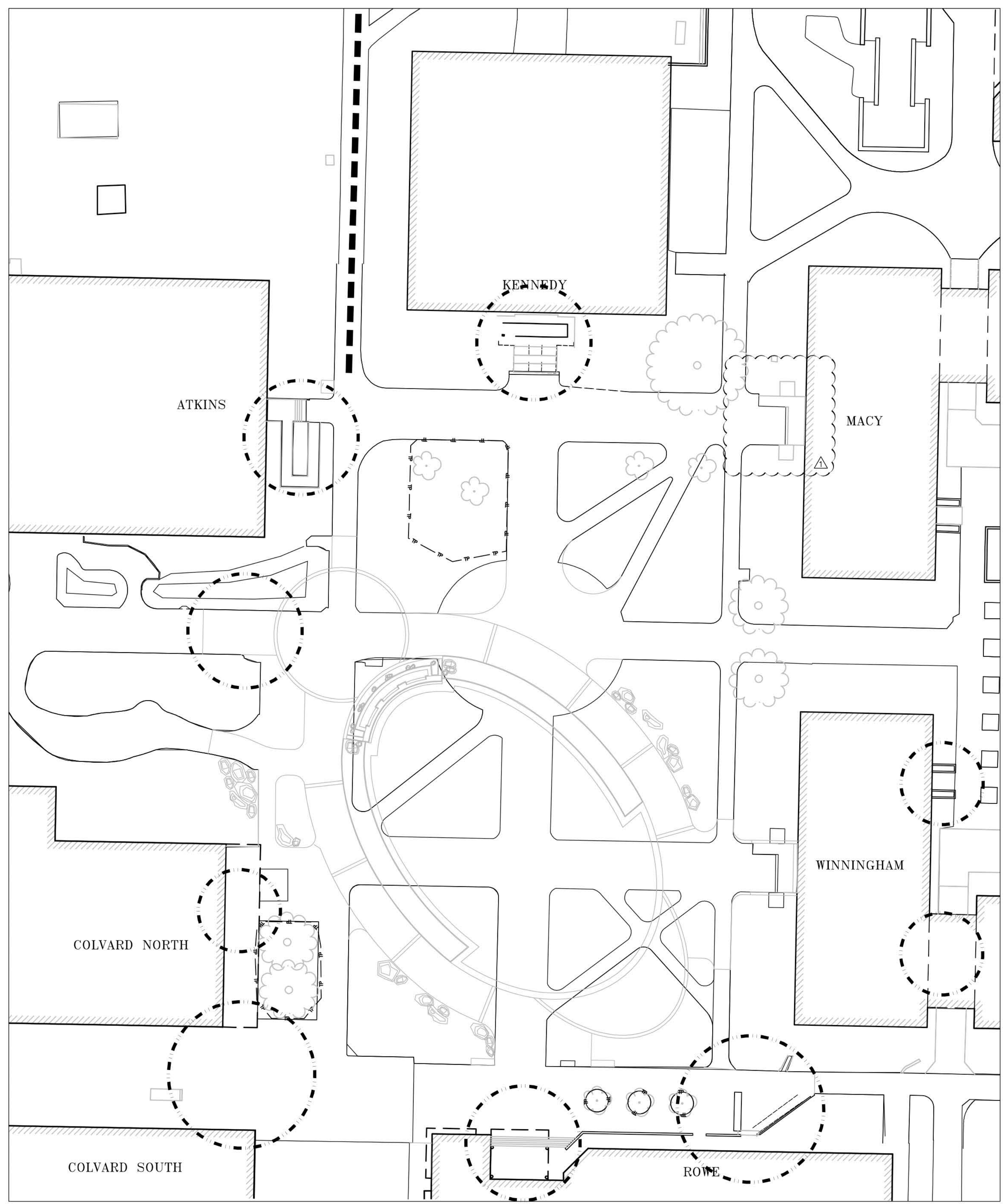

SITE LEGEND

- CONSTRUCTION SITE ACCESS
- - - PEDESTRIAN ACCESS POINTS TO REMAIN OPEN
- - - TEMPORARY TREE PROTECTION

CONSTRUCTION MANAGEMENT NOTES

1. CONSTRUCTION COORDINATION SHALL BE HANDLED THROUGH THE UNIVERSITY'S CAPITAL PROJECTS' CONSTRUCTION MANAGER.
2. PRIOR TO CONSTRUCTION, THERE MUST BE COORDINATION WITH THE UNIVERSITY'S CONSTRUCTION MANAGER TO OBTAIN/LOCATE UNIVERSITY OWNED UTILITIES.
3. CONTRACTOR SHALL SUBMIT TO THE UNIVERSITY CAPITAL PROJECTS CONSTRUCTION MANAGER AND DESIGNER A CONSTRUCTION PHASING PLAN. PLAN SHALL ADDRESS MAINTENANCE AND PROTECTION OF PEDESTRIAN WALKWAYS AND ACCESS THROUGHOUT CONSTRUCTION. ADA ACCESS MUST BE MAINTAINED THROUGHOUT CONSTRUCTION.
4. CONTRACTOR IS RESPONSIBLE FOR BIDDING FENCING, FLAGMEN, AND OTHER APPLICABLE CONSTRUCTION MANAGEMENT ELEMENTS AS NECESSARY PER THE CONTRACTOR'S PROPOSED CONSTRUCTION PHASING PLAN.
5. GENERAL LOCATION OF LAYDOWN AREA TO BE OFF LOT 5 ON MARTIN VILLAGE LN. COORDINATE FINAL LAYDOWN AREA WITH UNIVERSITY CAPITAL PROJECTS CONSTRUCTION MANAGER.

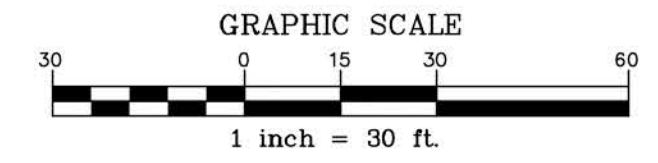

DATE PLOTTED (DD-MN-YY)

THE JOHN R. MCADAMS COMPANY, INC.
 3436 Torrington Way
 Suite 110
 Charlotte, North Carolina 28277
 License No.: C-0283
 (800) 733-5646 • McAdamsCo.com

MCADAMS



REVISIONS:

1	2017-08-22	ADDENDUM #1
---	------------	-------------

OWNER:
UNIVERSITY OF NORTH CAROLINA AT CHARLOTTE
 CHARLOTTE, NC 28223

BELK PLAZA REVITALIZATION CONSTRUCTION DRAWINGS
 CHARLOTTE, MECKLENBURG COUNTY, NORTH CAROLINA
CONSTRUCTION MANAGEMENT PLAN

PROJECT NO.	CLT-16010
FILENAME	UNC16010-C6
CHECKED BY:	KMM
DRAWN BY:	KMM
SCALE:	VARIABLE
DATE:	2017-07-26
SHEET NO.	C-6

